

# Array

Designed by George Simons, 2018

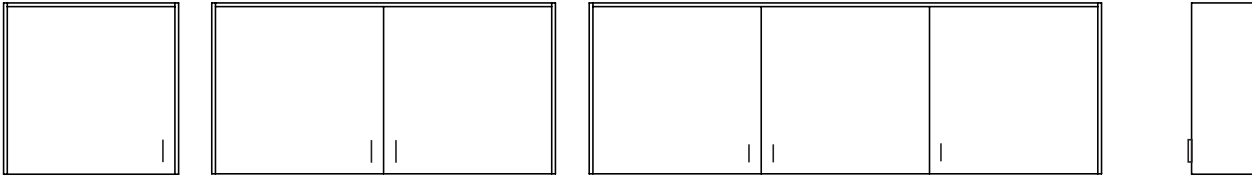

- Overhead Storage - Single      GS02-U1
- Overhead Storage - Double      GS02-U2
- Overhead Storage - Triple      GS02-U3



**Overhead Storage - Single** GS02-U1 / **Double** GS02-U2 / **Triple** GS02-U3

A simple and functional modular casework system designed to allow consistency of lines, forms, and details across a broad range of standard and custom configurations.

Depth	Width	Height	
8.75" / 13"	23.5"	23.25"	- Single
8.75" / 13"	46.25"	23.25"	- Double
8.75" / 13"	70"	23.25"	- Triple

**Features**

- Adjustable interior shelves
- Delineated inner and outer cases allow material layering
- Open-line laminates for outer case and doors
- Flush-mount hanging system maximizes space
- Inset doors ensure clean lines and detailing
- Soft-close hinges provide quiet operation

**Options**

- Bow, Tab, or Straight pulls
- Extra adjustable shelf
- Glove cut-outs (group of 3)
- Veneer outer wrap
- Veneer doors

**Specifiable Materials**

- Laminates: open line HPL
- Pulls: Brushed nickel
- Wood veneer: Catalyzed Lacquer over Ash or Walnut, Stain

**Colors and Finishes**

Please see our Finishes Palette online to review actual swatches, specs, and to order samples → [Memo Finishes Page](#)

**Content and Construction**

Carcass and case: Particle board core with Melamine face  
Fronts and case wrap: Particle board core with HPL or veneer face  
Construction: Tab and slot joinery  
Mounting: Extruded French cleat

**Testing**

Memo products are designed to meet the requirements of the BIFMA test protocol and are also subject to additional performance requirements in order to withstand the rigors of commercial interiors.

For specific testing information, please contact us at [info@memofurniture.com](mailto:info@memofurniture.com).

**Environmental**

For inquiries regarding Greenguard, MBDC, LEED, and LBC, please contact us at [info@memofurniture.com](mailto:info@memofurniture.com).

**Notes**

- Case wrap can be specified as full, open-left, open-right, or open-both, depending on configuration. Specification occurs during quote process.
- Custom sizes available upon request. Subject to price increase.
- Doors can be specified Hinge-Right or Hinge-Left, during the quote process.
- Standard edge banding is PVC. Non-PVC options can be procured at customer request and subject to upcharges.
- Designed and made in Seattle, Washington, USA.