

Pricelist  
2018

**memo**

**Contents**

03	Terms of Sale	60	<b>Array Casework</b>
04	Limited Lifetime Warranty	60	Overhead Storage - Single
05	Customer Service	62	Overhead Storage - Double
06	Carton and Crate Fees	64	Overhead Storage - Triple
07	Finishes	66	Drawer Module - Single
09	Laminates	68	Drawer Module - Double
15	Textiles	70	Drawer Module - Triple
28	<b>Prose Seating</b>	72	Wardrobe, Floor Based
28	Side Chair with Arms	74	Wardrobe, Wall Mounted - Basic
30	Side Chair Armless	76	Wardrobe, Wall Mounted - Low
32	Plus Chair	78	<b>Array Work Stations</b>
34	Two Seater	78	Compact Work Station
36	Three Seater	80	<b>Array Sink Stations</b>
38	Settee	80	Sink
40	Pull-Up Chair	82	Sink + Drawer
42	High Back Chair		
44	Bench		
46	Lounge		
48	Loveseat		
50	Sofa		
52	Ottoman		
54	Folding Chair		
56	<b>Prose Tables</b>		
56	Free-Standing End Table		
57	Free-Standing Coffee Table		
58	<b>Tenet</b>		
58	Daybed		

**Terms of Sale****Pricing Policy**

All prices shown for products and accessories are manufacturer's suggested list price. Prices shown do not include appropriate taxes, cartoning or crating, storage and installation charges. Memo reserves the right to amend price lists, change designs and/or add or discontinue models without prior notice. Price list of latest date supersedes and cancels all previous lists. All orders accepted are subject to prices upon receipt of order.

**Payment Terms**

Except as otherwise specified, all orders require a 50% deposit with the balance due with thirty (30) days from the invoice date. All payments are payable in U.S. dollars. Lead times start after the receipt of deposit. Payments not made by the due date may incur, at the sole discretion of Memo, a late payment service charge of 1.5% per month. All payments and deposits are non-refundable.

**Changes and Cancellations**

Customers will receive a written confirmation of pricing, credit terms and estimated completion date. Changes to orders or cancellations made after production has begun will carry extra charges based on expenses incurred.

**Shipping**

Memo list prices include standard surface freight to any point within the 48 contiguous United States for orders greater than \$100,000 List. For orders less than \$100,000 list and shipments to Alaska, Hawaii and International destinations, additional shipping and handling charges will apply. Additional freight charges will be provided at the time of quote. Orders are shipped blanket wrapped as standard. If cartoning is requested additional charges will apply. For a schedule of cartoning charges, please consult page 06 of this pricelist.

**Freight Claims**

Product is shipped FOB Factory, freight prepaid and allowed via truck. The title of goods changes to the purchaser when merchandise leaves Memo's dock and any subsequent freight damage and all freight claims are the responsibility of the purchaser. All shipments are transferred to the transportation company in good condition.

Continues...

**Terms of Sale** continued...

### **Custom Requests**

Requests to modify existing products (Modifications) or to produce ground-up solutions (Specials) should be submitted to our customer service group, at which time they will be assessed and submitted for design and engineering approval. Upon approval, a price and lead-time quote will be generated and provided for customer review and acceptance.

### Limited Lifetime Warranty

Memo Furniture warrants its products, to the original user and for the original purpose, to be free of defects in design, material and workmanship, given normal use and care for the lifetime of the product from the date of invoice. This warranty does not include damage from accident, alteration, misuse, normal wear and tear, transportation or improper installation and maintenance.

During the warranty period, Memo Furniture, at its option, will repair or replace any product which, upon inspection by Memo Furniture or its designated representative, is deemed to be defective in materials or workmanship and is covered by this warranty.

This warranty does not apply to defects in components not manufactured by Memo Furniture. In these cases, the warranty period provided by the supplier of the component will apply. The liability of Memo Furniture is limited to furnishing new parts as may be necessary to replace any item that may prove to be defective in material or workmanship. Memo Furniture will make every effort to replace parts if they are available from the supplier of those parts. We will not assume liability of charges for labor, consequential expenses or damages incurred.

Textiles and leathers are not warranted against fading or normal wear, customer induced cuts or tears or irregularities in the registration of printed textile patterns. Due to natural variations, in which Memo Furniture has no control, this warranty does not extend to color, grain, texture or the durability or suitability of any exterior surface coatings or treatments.

This warranty is void in cases of damage in transit, negligence, abuse, abnormal usage, misuse, accidents, and improper cleaning and maintenance. Normal aging and wear of woven and non-woven upholstery are exempt from this warranty.

All other warranties, expressed or implied, are excluded. Memo Furniture shall not be liable for incidental or consequential damages of any sort.

If you have any questions or wish to file a claim against this warranty, please contact Customer Service at +1 206 995 8780.

## Customer Service

Memo's Customer Service Group is trained to assist with quotes, orders, custom requests, product details, warranty inquiries, and to answer general questions.

We can be reached Monday through Friday, 7:00 am – 5:00 pm Pacific Time, directly at +1 206 995 8780 or via email at [service@memofurniture.com](mailto:service@memofurniture.com).

Inquiries received after-hours via voicemail or email will receive a response before the close of business on the following business day.

Please visit [www.memofurniture.com](http://www.memofurniture.com) for answers to most questions including product prices, specifications, photos, SketchUp and Revit files, and marketing material. Additionally, a local sales representative can assist you further. Contact names and numbers are also available on our website.

**Cartoning and Crate Fee Schedule**

Product	NET		
<b>Prose Seating</b>			
Side Chair	\$75	<b>Array Overhead Storage</b>	
Side Chair Armless	\$75	Overhead Storage - Sngl.	\$75
Plus Chair	\$85	Overhead Storage - Dbl.	\$100
Settee	\$125	Overhead Storage - Trpl.	\$125
Two-Seat Tandem	\$150		
Three-Seat Tandem	\$175	<b>Array Work Stations</b>	
High Back Chair	\$150	Compact Work Station	\$150
Bench	\$125		
Lounge	\$125	<b>Array Sink Stations</b>	
Loveseat	\$150	Sink Only	\$75
Sofa	\$175	Sink + Drawer Left	\$125
Ottoman	\$50	Sink + Drawer Right	\$125
Folding Chair	\$50		
Pull-Up Chair	\$85	<b>Array Wardrobes</b>	
Free-Standing End Table	\$50	Wardrobe, Floor Based	\$125
Free-Standing Coffee Table	\$50	Wall Mounted, Basic	\$125
		Wall Mounted, Low	\$125
<b>Tenet</b>			
Tenet Daybed	\$250		
<b>Array Drawer Modules</b>			
Drawer Module - Single	\$75		
Drawer Module - Double	\$100		
Drawer Module - Triple	\$125		

For larger quantities carton fees may be reduced from the stated prices and reflected in the quote.

## Finishes

Memo offers a range of proprietary colors and finishes on select materials, as well as support for a broad range of open line laminates. Our finishes have been curated to offer a foundation of essential base neutrals, to which accents and stronger colors can be added.

Memo offers finish and pattern selections in the following materials:

### High Pressure Laminate (HPL)

Our prices account for any HPL selection from our approved Laminates schedule on page 09. Laminates not listed can be reviewed and quoted on a project-by-project basis by contacting our customer service group at [service@memofurniture.com](mailto:service@memofurniture.com) or +1 206 995 8780.

### Metal Powder Coat

Our powder coats are applied to both steel and aluminum, and are available in textured and smooth finishes. Powder coating is extremely durable and emits zero pollutants once cured.

### Natural Stone and Quartz

Memo offers natural stone and quartz on select table and horizontal surface tops. Our stone is hand selected for the highest quality slabs however natural variances will occur from product to product.

### Solid Surface

Memo has standardized on select Corian solid surface products. Corian, is a non-porous high durability product that is stain resistant, easy to clean, and easily repairable.

### Stainless Steel

Select products offer stainless steel as an alternate to Powder Coated Metal. Our stainless is 200 series, treated with a #4 brushed surface finish.

### Wood & Veneer

Our products utilize both solid wood and wood veneer, and are offered in either Ash or Walnut. Products with edge profiles will include a matching wood edge. Wood products are finished in a resilient, long lasting, conversion varnish.



**Finishes****Metal Powder Coat**

Light Grey Texture	MLG
Steel Grey Gloss	MSG
Med Bronze Gloss	MMB
Dark Grey Texture	MDG
Silver Metallic Gloss	MSM

**Natural Stone**

White Grey Marble	RWM
Valente Pearle Quartz	RVQ
Black Portoro Quartz	RPQ

**Solid Surface**

Cameo White	CCW
Pearl Grey	CPW
Concrete	CCT
Carbon Concrete	CCC

**Stainless Steel**

Brushed Stainless Steel	MSS
-------------------------	-----

**Wood & Veneer**

Clear over Ash	WCA
Oak Over Ash	WOA
Grey Over Ash	WGA
Walnut Over Ash	WWA
Clear Over Walnut	WCW
Navy Painted Wood	WNP

**Standard Laminates Schedule**

**Formica Laminates**

All Formica laminates are in Matte 58 finish, unless marked by an asterisk (\*)

**Solids**

Brite White*	459
Sail White*	463
Graystone	464
Graphite	837
Stop Red	839
Spectrum Red	845
Spectrum Blue	851
Pumice	858
Desert Beige	899
Platinum	902
Black*	909
Storm	912
Marine Blue	914
Neutral White	918
Almond	920
Surf	923
Folkstone	927
Mouse	928
Oyster Gray	929
Antique White	932
Mission White	933
Pearl	934
White*	949
Fog	961
Hunter Green	967
Navy Blue	969
Citadel	1097
Chrome Yellow	1485
Eggplant	1517
Blackened Bronze	1519
Infinity	1520
Fox	1994
Dark Chocolate	2200
Terril*	2297
Sarum Grey	2770
Clementine	2962

Otter	3202
Sol	3209
Nocturne	5323
Earth	5342
Fossil*	5349
Vibrant Green	6901
Grenadine	6902
Cassis	6903
Amarena*	6907
Dover White*	7197
Spectrum Green	7897
New Burgundy	7966
Mojave	8751
Winter Sky	8792
Green Slate	8793
Enamel	8794
Matrix Blue	8795
Leaf Green	8820
Just Blue	8821
Just Rose*	8858

**Patterns**

Ebony Oxide	299
Sail White Oxide	300
Antique White Oxide	303
Stone Grafix	503
Folkstone Grafix	507
Graphite Grafix	515
Folkstone Celesta	692
White Onyx*	827
Mineral Sepia	3446
Mineral Umber	3449
Mineral Jet*	3450
Santa Cecilia Gold	3452
Parquet Latte	3453
Mocha Travertine	3456
Belmonte Granite	3496

**Standard Laminates Schedule**

**Formica Laminates continued...**

All Formica laminates are in Matte 58 finish, unless marked by an asterisk (\*)

Storm Solidz	3505	Argento Romano	6697
Sand Crystall	3517	Paloma Polar	6698
Flint Crystall	3518	Paloma Bisque	6729
Perlato Granite	3522	Mineral Spa	6920
Giallo Granite	3523	Charcoal Boomerang	6942
Autumn Indian Slate	3687	Colorado Slate	7014
Himalayan Slate	3689	Navy Grafix	7018
Basalt Slate	3690	Natural Canvas	7022
Labrador Granite	3692	Earth Wash	7213
Shoji Screen	3696	Lime Stone	7264
Beluga Beige	3698	Sand Stone	7265
Dogbone White	5281	Concrete Stone	7267
Neutral Weft	5875	Carrara Envision	7494
Earthen Warp	5880	Noir Envision	7500
Chocolate Warp	5881	Flax Gauze	7708
Citadel Warp	5882	Butterum Granite	7732
Wheat Strand	6212	Tuscan Marble	7736
Smoke Quarstz	6220	MDF Solidz	7812
Brazilian Brown Granite*	6222	Cardboard Solidz	7813
Venetian Gold Granite	6223	Denim Twill	8814
Ivory Kashmire	6226	White Drops	8824
Amber Kashmire	6227	Neutral Twill	8826
Kerala Granite	6272	Sarum Twill	8827
Midnight Stone	6280	Earthen Twill	8828
Wenge Strand	6306	Graphite Twill	8829
Burnt Strand	6307	Elemental Concrete	8830
Neo Cloud	6314	Elemental Stone	8831
Weathered Cement NT	6317	Rolled Steel	8917
Paloma Dark Gray	6366	Blackened Steel	8918
Elemental Oxide	6417	Bronzed Steel	8919
Sarum Duotex	6447	Bubble Science	8956
Infinity Duotex	6448	Bubble Organic	8957
Charcoal Duotex	6449	Bubble Art	8958
Folkstone Hex	6473	White Twill	9285
Storm Hex	6474	White Bardiglio*	9306
Elemental Blue Steel	6475	Silver Shalestone*	9307
Carrara Bianco	6696	Geriba Gray*	9308

**Standard Laminates Schedule**

**Formica Laminates continued...**

All Formica laminates are in Matte 58 finish, unless marked by an asterisk (\*)

White Marble Herringbone	9310	Smoky Walnut Woodline*	6926
White Ice Granite*	9476	Amber Maple	7012
Marfil Cream	9477	Figured Annigre	7284
Marfil Antico	9478	Violin Figured Annigre	7285
Silver Quartzite	9497	Ginger Root Maple	7288
White Shalestone*	9525	Natural Birch	7481
Black Shalestone*	9527	Cherry Birch	7484
Silver Galaxy Slate*	9528	Victorian Mahogany	7583
Sea Salt*	9529	Natural Cherry	7737
Smoked Sea Salt*	9532	Cognac Maple	7738
		Cocoa Maple	7739
		Select Cherry*	7759
		Ashen Ribbonwood	8839
		White Ash*	8841
		Weathered Ash*	8842
		Natural Ash*	8843
		Aged Ash*	8844
		Bleached Legno	8845
		Oiled Legno	8846
		Jarraah Legno	8847
		Blackened Legno	8848
		Natural Teak	8849
		White Painted Wood*	8902
		Waxed Maple	8905
		Danish Maple	8906
		Weathered Fiberwood*	8914
		Walnut Fiberwood*	8915
		Zebrano*	9011
		Ebony*	9012
		Auburn Maple	9256
		Glow Maple	9257
		Silver Oak Herringbone	9311
		Planked Urban Oak*	9312
		Salvage Planked Elm*	9480
		Oxidized Beamwood*	9484
		Umbra Oak*	9524
		Hard Rock Maple	86992
			06-22-2018

**Woodgrains**

Finnish Oak	118
Natural Oak	346
Blossom Cherrywood	758
Myriad Ribbonwood	863
Ebony Ribbonwood	873
Vosges Pear*	1150
Black Walnut	3485
Rattan Cane	3699
Oiled Olivewood*	5481
Oiled Walnut*	5487
Smoky Brown Pear*	5488
Espresso Pear*	5489
Pecan Woodline	5883
Chestnut Woodline	5884
Sorrel Cherry*	5886
Millennium Oak*	5887
Planked Deluxe Pear*	6206
Glamour Cherry*	6208
Timberworks*	6318
Natural Walnut*	6401
Thermo Walnut*	6402
Chalked Knotty Ash	6437
Washed Knotty Ash	6438
Smoked Knotty Ash	6440
Maple Woodline*	6925

**Standard Laminates Schedule**

**Formica Laminates continued...**

All Formica laminates are in Matte 58 finish, unless marked by an asterisk (\*)

**MicroDot**

Sail White	463
Black	909
White	949
Fog	961
Citadel	1097
Dark Chocolate	2200
Terril	2297
Sol	3209
Vibrant Green	6901
Grenadine	6902
Cassis	6903

**Sculpted**

Black	909
Neutral White	918
Folkstone	927
White	949
Dark Chocolate	2200
Storm Solidz	3505
Earth	5342
Fossil	5349
Grenadine	6902
MDF Solidz	7812
Cardboard Solidz	7813

**Standard Laminates Schedule**

**Wilsonart Laminates**

Wilsonart laminates are in either Finish 38 or Finish 60.

**Finish 38**

Tumbled Roca	4835
Sheer Mesh	4876
Grey Mesh	4877
Pewter Mesh	4878
Steel Mesh	4879
Carbon Mesh	4880
Oiled Soapstone	4882
Sable Soapstone	4883
Green Soapstone	4885
Pearl Soapstone	4886
Tan Soapstone	4887
Rustic Slate	4888
Desert Springs	4904
Spicewood Springs	4905
Deep Springs	4907
Soft Gold Mesh	4911
Gilded Mesh	4912
White Carrara	4924
Bordeaux Juparana	4929
White Juparana	4931
Pinball	4937
Crisp Linen	4942
Classic Linen	4943
Casual Linen	4944
Organic Cotton	4945
Natural Cotton	4946
Raw Cotton	4947
Gesso Tracery	4962
Basket Weaving 101	4965
Calacatta Oro	4981
Rugged Linen	4989
Flax Linen	4990
Pressed Linen	4991
Tailored Linen	4992
Irish Linen	4993
High Rise	4996

White Cascade	5003
Dusk Cascade	5004
Sierra Cascade	5005
Tuscan Walnut	7921
Monticello Maple	7925
Castle Oak	7928
Huntington Maple	7929
River Cherry	7937
New Age Oak	7938
Brazilwood	7946
Harvest Maple	7953
Natural Rift	7954
Buka Bark	7982
Boardwalk Oak	7983
Mangalore Mango	7984
Morelia Mango	7985
Pasadena Oak	7986
Palisades Oak	7987
Hibiscus Cherry	7988
Persian Cherry	7989
Mission Maple	7990
NeoWalnut	7991
Pinnacle Walnut	7992
Florence Walnut	7993
Lowell Ash	7994
Sterling Ash	7995
Natural Recon	7996
Ebony Recon	7997

**Finish 60**

Limber Maple	10734
Fonthill Pear	10745
Kensington Maple	10776
Grey	1500
Putty	1503
Beige	1530
Light Beige	1531

**Standard Laminates Schedule**

**Wilsonart Laminates continued...**

Wilsonart laminates are in either Finish 38 or Finish 60.

White	1570	Western Suede	4871
Antique White	1572	Ginseng Tea	4909
Frosty White	1573	Eggplant	4913
Black	1595	Tangerine	4915
Oxide	1787	Sprout	4918
Almond Leather	2932	Fired Steel	4994
Grey Glace	4142	Forged Steel	4995
Neutral Glace	4143	Pebble Piazza	5009
Pampas	4166	Wild Cherry	7054
White Nebula	4621	Natural Pear	7061
Graphite Nebula	4623	Bannister Oak	7806
Cloud Nebula	4630	Solar Oak	7816
Natural Nebula	4633	Beigewood	7850
Navy Legacy	4651	Fusion Maple	7909
Bronze Legacy	4656	Manitoba Maple	7911
Tawny Legacy	4663	Port	D14
Green Tigris	4667	Atlantis	D25
Natural Tigris	4669	Natural Almond	D30
Milano Amber	4724	Hollyberry	D307
Milano Brown	4725	Platinum	D315
Milano Quartz	4726	Brittany Blue	D321
Maroochy Brush	4745	Pepperdust	D327
Woolamai Brush	4746	Designer White	D354
Mystique Dawn	4762	Lapis Blue	D417
Pewter Brush	4779	Linen	D427
Burnished Chestnut	4796	Alabaster	D431
Titanium EV	4810	Wallaby	D439
Silicon EV	4811	Coffee Bean	D495
Carbon EV	4820	Orange Grove	D501
Antique Brush	4823	Ocean	D502
Desert Zephyr	4841	Cement	D503
Loden Zephyr	4844	Khaki Brown	D50
Twilight Zephyr	4845	Pewter	D73
Cloud Zephyr	4856	North Sea	D90
Shadow Zephyr	4857	Slate Grey	D91
Spiced Zephyr	4859	Dove Grey	D92
Western White	4869	Shadow	D96 06-22-2018

## Textiles

### Graded-in Textiles

Memo has partnered with Maharam to offer graded-in textiles. All graded-in textile prices are listed in our *textile pricing table* as Net on page 19 and are handled separately from product prices, which are provided at List. To calculate total textile price, determine product yardage as listed on the product pricing page, and multiply by the price per yard figures in our *textile pricing table* on page 19.

Memo is glad to grade in textiles from suppliers other than Maharam, per customer requests. Please contact us to submit grading requests.

When specifying graded-in textiles the projected completion date of your order may exceed our normal lead times due to constraints of the textile supplier. In such instances, Memo will promptly communicate such delays and advise on adjusted lead times.

Textiles are subject to the quality and shipping standards of the provider. Memo assumes no responsibility for defects, color inaccuracies, shortages, wear, or performance of textiles.

### Ordering a Textile Sample

Samples can be ordered by visiting the textile provider's website.



## Textiles

### Customer's Own Material (COM)

While we recommend selecting from our graded-in Maharam textile offer for the most streamlined process, we also provide the option to use COM. Memo, however, reserves the right to reject textiles which are unsuitable for upholstery on our products. This may be due to inadequate textile weight or unique elastic qualities which impact the integrity of upholstery on our products.

To select fabric outside of the graded-in fabric program, a few steps are required. Memo provides the total yardage for each product on its product spec sheets and pricelist reference pages. These published yardage figures are based on the application conditions of the cutting pattern for each product as well as managing quality issues. Certain textiles, depending on their width and/or repeat, may require additional yardage beyond the figures in our pricing pages. To calculate additional yardage, see our guidelines on page 18. Memo will also provide yardage requirements upon receipt of an order.

Upon receipt of the textile, Memo will immediately advise if flaws or deficiencies in the order are discovered. Memo assumes no responsibility for defects, color inaccuracies, shortages, wear, or sub-standard performance of the specified textiles.

Note that Memo will dispose of excess upholstery material at the time of shipment unless expressly requested to return it with the product shipment.

### Customer's Own Leather (COL)

Please contact our customer service group at [service@memofurniture.com](mailto:service@memofurniture.com) or +1 206 995 8780.

## Textiles

### **Delivery of Customer's Own Material (COM)**

Customers are responsible for ensuring delivery of COM fabric to Memo. Orders for COM-upholstered products will be scheduled into production upon receipt of all COM and swatches. Please work with our customer service group to procure written confirmation of textile supplier ship dates to ensure the best possible lead time. Since shipment of COM orders depends upon textile availability, lead times may vary.

### **When supplying COM textiles to Memo, please include the following info:**

Textile supplier  
Pattern name and number  
Color name and number  
A representative fabric swatch for identification purposes with face side marked  
Any nonstandard treatments applied to the fabric  
Any additional documentation

### **All COM or COL must be sent prepaid to the following address and tagged as follows:**

C/O Memo Furniture  
4660 Colorado Avenue South, Suite A  
Seattle, WA 98134  
Dealer name  
P.O. #  
Order code # (for each fabric)

## Textiles

### Order Requirements for Customer's Own Material (COM)

Memo reserves the right to reject textiles or materials. Textiles requiring secondary backing or coatings should be treated prior to shipping to Memo. All yardage figures listed in Memo product spec sheets and pricelist reference pages are based on 54" Wide, Plain Fabric, Railroaded Applications. If textile is to be Non-Railroaded, please specify and follow the textile requirement yardage charts below.

### Increases for Textile Width and/or Repeat

In the event that COM textile is both less than 54" wide and has a repeat, add only the greater of the two increases shown. For textiles less than 54" wide add 12% to overall textile yardage required. For textiles that require matching (stripes, plaids, prints, pattern repeats) it is Memo's policy to match all pattern repeats, stripes, prints or plaids unless specified 'No Matching Required' on purchase order.

### Railroad Applications

Repeat 3"-7.5"	Add 06%
Repeat 7.6"-14.9"	Add 12%
Repeat 15" & Above	Add 25%

### Non-Railroad Applications: Multiple Seating, Side Chairs and Benches

Repeat 7" & Less	Add 20%
Repeat 7.1"-14.9"	Add 27%
Repeat 15" & Above	Add 34%

### Non-Railroad Applications: Lounge Seating, High Back Chairs

Repeat 7" & Less	Add 30%
Repeat 7.1"-14.9"	Add 47%
Repeat 15" & Above	Add 44%

### Order Requirements for Customer's Own Leather (COL)

COL orders are based on an average hide size of 45 square feet of usable leather and 19 feet per yard. Due to shape and quality issues with some leather, additional hides may be required after receipt of COL. Ship full hides only.

To convert COM yardage requirements to COL square footage and number of hides, multiply the COM yardage by 19. Example: 5 yards x 19 = 95 square feet.

**Textile Pricing Schedule** Graded-in Maharam

For total textile price (net), multiply textile pricing (below) by the required yardage indicated on a given product page.

Pattern Name	Pattern Number	Price per Yard (net)
A Band Apart	466000	\$253.18
Abacus	466118	\$64.22
Abacus Standard	466140	\$41.99
Across	465964	\$65.46
Aftermath	466169	\$240.83
Agency	466001	\$253.18
Akimbo	464770	\$66.07
Albemarle	466435	\$111.15
Alloy	466064	\$50.64
Alpaca Epingle	465902	\$222.30
Alpaca Herringbone	465898	\$169.20
Alpaca Velvet	465901	\$222.30
Alter	464880	\$49.40
Anagram	466067	\$81.51
Apt	466392	\$72.87
Arabesque	466204	\$129.68
Aria	459950	\$129.68
Array	466300	\$53.11
Article	458600	\$35.82
Assembled Check	466345	\$265.53
Balustrade	463120	\$74.10
Banister	466263	\$64.22
Bar	466227	\$40.76
Bar Crypton	466234	\$56.81
Basel By Kvadrat	466214	\$58.50
Bask	700009	\$14.82
Bavaria	466162	\$339.63
Bavaria Stripe	466161	\$209.95
Beacon	466405	\$77.81
Beam	466119	\$66.69
Beside	464020	\$61.75
Bespoke Stripe	463540	\$179.08
Bevel	466131	\$43.84
Big Stripe	466174	\$205.01
Bind	466437	\$104.98
Bitmap	466066	\$45.08
Blip	466129	\$67.93

Blocks	466209	\$223.54
Borders	466082	\$321.10
Boundary	466193	\$48.17
Bright Angle	466331	\$93.86
Bright Cube	466329	\$93.86
Bright Grid	466330	\$93.86
Brim	466350	\$74.10
Brindle	466418	\$37.05
Brio	466386	\$55.58
Brushed Camel	465977	\$296.40
Brushed Cashmere	465978	\$648.38
Brushed Merino	465983	\$308.75
Canvas by Kvadrat	466185	\$62.40
Caper	466384	\$39.52
Carapace	466261	\$199.80
Cartouche	465988	\$64.22
Cashmere Ripple	465979	\$753.35
Centric	466056	\$83.98
Chalet	466324	\$66.69
Chance	464010	\$64.22
Chasm	466404	\$55.58
Checker	459830	\$135.85
Chenille Cord	407808	\$85.83
Chime	465350	\$43.84
Chock	466219	\$55.58
Chroma	466303	\$308.75
Circles	458310	\$129.68
Circuit	466089	\$53.11
Clamber	466385	\$61.75
Clara by Kvadrat	466025	\$62.40
Coach Cloth	458950	\$148.20
Coda by Kvadrat	464480	\$114.40
Coin	466233	\$40.76
Coin Crypton	466236	\$56.81
Coincide	465808	\$38.29
Coincide High Performance	466132	\$56.81
Colline by Kvadrat	466155	\$67.60
Colorfield	466315	\$259.35
Colorwheel	466163	\$92.63
Column	466192	\$64.84
Compartment	466154	\$244.53
Compound	466196	\$59.28

Conduit	466428	\$39.52
Confetti	466203	\$113.62
Cotton Velvet	466199	\$154.38
Couple	466010	\$65.46
Crew	466149	\$65.46
Crosspatch	458920	\$129.68
Crush	464780	\$64.22
Cursive	466335	\$76.57
Cycle	466275	\$46.93
Dapper	466316	\$46.93
Dart	464040	\$65.46
Decode	464800	\$64.84
Deconstructed Rose	466086	\$240.83
Design 9297	465230	\$133.38
Dingbats	465994	\$113.62
Disc	466221	\$43.23
Disperse	466017	\$58.66
Ditto	465993	\$69.16
Divide	466220	\$43.23
Divide Crypton	466238	\$58.05
Divina by Kvadrat	460730	\$76.70
Divina MD by Kvadrat	466150	\$76.70
Divina Melange by Kvadrat	460830	\$76.70
Dot Pattern	458300	\$129.68
Dots	466411	\$117.33
Double Triangles	459840	\$135.85
Draft	700002	\$19.76
Drape	466145	\$64.22
Dwell	466419	\$30.88
Eden	466258	\$232.18
Ellipsis	466334	\$58.05
Emboss	466281	\$65.46
Emit	466378	\$40.76
Enmesh	466338	\$48.17
Entwine	466397	\$83.98
Epingle Stripe	466007	\$193.90
Equate	466383	\$55.58
Exaggerated Plaid	466039	\$148.20
Exchange	466027	\$46.93
Facets	459850	\$135.85
Fasten	466053	\$71.63
Fathom	466013	\$40.14

Feature	466343	\$56.81
Floret	464070	\$65.46
Fluent Crypton	466073	\$62.99
Fluted Silk	465982	\$123.50
Flutter	466430	\$185.25
Focus	465910	\$40.75
Fold	466292	\$65.46
Foliage	466257	\$232.18
Forest Nap by Kvadrat	466367	\$52.00
Fraction	466137	\$64.22
Fruit	466262	\$113.62
Furrow	466379	\$55.58
Galaxy by Kvadrat	466306	\$71.50
Garden	466134	\$92.63
Geometri	459970	\$142.03
Grade	466260	\$74.10
Grid	466210	\$223.54
Grove	466344	\$59.28
Hallingdal by Kvadrat	460760	\$87.10
Hedge	466298	\$61.75
Helix	466271	\$80.28
Hero by Kvadrat	466318	\$61.10
Herringbone Stripe	465945	\$179.08
Hewn	466398	\$86.45
Highfield by Kvadrat	465957	\$91.00
Horsehair Basket	465981	\$531.05
Horsehair Check	465980	\$586.63
Horsehair Striae	465984	\$456.95
Houndstooth	466253	\$113.62
Hours	466092	\$363.09
Huddle	466420	\$166.73
Hue	700003	\$22.23
Imbue	466375	\$96.33
Industry	466255	\$253.18
Inlay	466353	\$113.62
Insignia	466308	\$72.87
Instill	466351	\$48.17
Jacobs Coat	462270	\$164.26
Joist	466403	\$92.63
Keen	466433	\$43.23
Kindred	466166	\$59.28
Knot	466248	\$119.80

Lanalux	466240	\$376.68
Lariat	440401	\$42.61
Latch	466301	\$76.57
Layers Garden	465916	\$191.43
Layers Garden Double	465917	\$370.50
Layers Park	465918	\$191.43
Layers Park Double	465919	\$370.50
Layers Vineyard Small	465920	\$191.43
Ledger	463770	\$44.46
Lens	466323	\$48.17
Letters	462560	\$143.00
Lift	466302	\$80.28
Limn	466407	\$91.39
Lineage	466127	\$40.14
Link	466328	\$74.10
Lithe	466394	\$59.28
Loam	700006	\$22.23
Lunar	466356	\$37.05
Manner	466177	\$32.11
Marquee	463890	\$38.90
Massive Paisley	465915	\$228.48
Matrix by Kvadrat	466212	\$93.60
Mechanism	465952	\$91.39
Medium	463490	\$35.82
Melange Tweed	461190	\$144.50
Meld	466387	\$33.35
Memory by Kvadrat	466211	\$76.70
Meridian	464710	\$55.58
Merit	466444	\$35.82
Mesh	466371	\$93.86
Messenger	458640	\$32.73
Metric	466014	\$32.73
Micro	466099	\$40.76
Mikado	459330	\$129.68
Milestone	403901	\$32.11
Millerstripe	462250	\$164.26
Mimic	466136	\$77.81
Mineral	466232	\$53.11
Mingled Plaid	466364	\$172.90
Minicheck	466268	\$135.85
Minimak	466026	\$62.37
Mister	466178	\$72.87



Mode	466337	\$34.58
Mohair Supreme	451801	\$175.37
Molly by Kvadrat	465640	\$66.30
Monk's Wool	457301	\$182.78
Mortise	466213	\$60.52
Motley	466360	\$48.17
Multiply	466341	\$39.52
Murmur	466446	\$30.88
Names	462510	\$135.85
Nestle	466388	\$123.50
Oblique	466222	\$38.29
Octave	466116	\$72.87
Offset	465951	\$85.22
Omen	466172	\$67.93
Optik	459960	\$142.03
Orakelblume	463900	\$133.38
Orbit	466415	\$39.52
Ottoman Stripe	466142	\$179.08
Pace	700011	\$14.20
Painted Stripe	465998	\$135.85
Palio	466107	\$117.33
Parched Silk	465974	\$142.03
Pare	466359	\$56.81
Parquet	466376	\$72.87
Pavement	459740	\$129.68
Paver	466111	\$69.16
Pebble Wool	457401	\$175.37
Pebble Wool Multi	461200	\$175.37
Pennant	466094	\$65.46
Periphery	465900	\$132.15
Pick	466224	\$38.29
Pick Crypton	466235	\$54.34
Pitch	466186	\$45.70
Plait	466052	\$46.93
Plume	466382	\$123.50
Ply Mesh Black/Tan	465020	\$135.85
Pocket	466243	\$62.99
Point	466090	\$150.67
Pressed Linen	466380	\$185.25
Quatrefoil	459340	\$129.68
Quay	466390	\$49.40
Quell	466366	\$135.85

Quick	465850	\$40.76
Radiant	462500	\$102.51
Reef	466332	\$107.45
Regatta	466189	\$72.87
Remix by Kvadrat	465956	\$62.40
Repeat Classic	462100	\$555.75
Repeat Classic Print	462160	\$617.50
Repeat Classic Stripe	462170	\$160.55
Repeat Dot	462110	\$463.13
Repeat Dot Print	462130	\$524.88
Repeat Dot Ring	462150	\$160.55
Rill	466370	\$46.93
Ring	466182	\$53.11
Rise	466146	\$64.22
Rove	466096	\$40.76
Rule	466190	\$72.87
Runner	466108	\$62.99
Runner Standard	466167	\$40.76
Salon	458670	\$116.09
Scape	466357	\$77.81
Schema	466336	\$59.28
Scuba	464930	\$49.40
Scute	466396	\$48.17
Seam	466289	\$45.70
Segmented Stripe	466373	\$111.15
Sequence	466179	\$58.05
Sequential Stripe	466377	\$197.60
Serif	466389	\$80.28
Serried	466408	\$71.63
Sheen	466246	\$58.05
Shuttle Standard	466168	\$48.17
Signal	466342	\$59.28
Silk Canvas	465985	\$123.50
Skein	466170	\$45.70
Slant	466358	\$60.52
Slumber	466365	\$123.50
Small Dot Pattern	458320	\$129.68
Soft Tweed	466197	\$113.62
Sort	466273	\$41.99
Span	466395	\$56.81
Spry	466414	\$41.99
Stack	465990	\$45.70

Star by Kvadrat	465966	\$93.60
Stark	700005	\$27.17
Stature	466180	\$46.93
Steady	465947	\$46.93
Steady Crypton	465946	\$61.75
Steelcut by Kvadrat	464470	\$72.80
Steelcut Trio by Kvadrat	465906	\$75.40
Steep	700007	\$16.06
Stick Tree by Kvadrat	466368	\$80.60
Stride	466252	\$50.64
Stripes	463980	\$180.31
Strum	466122	\$56.81
Study	466269	\$85.22
Sudden	463000	\$64.22
Superweave	466241	\$228.48
Surge	466314	\$54.34
Swathe	466416	\$83.98
Swivel	466374	\$62.99
Tailor	466173	\$46.31
Tally	465989	\$64.22
Tandem	466321	\$50.64
Tangram	466084	\$104.98
Taper	466413	\$92.63
Teatro	466309	\$93.86
Technic	466226	\$38.29
Telary	466151	\$98.80
Tempera	466426	\$61.75
Tend	466352	\$60.52
Terrace	466114	\$58.05
The Firm	465999	\$253.18
The Story of My Life	464670	\$148.20
Ticker	466304	\$58.05
Tilt	466256	\$62.99
Tinge	700010	\$19.76
Tonica by Kvadrat	460850	\$63.70
Tonus by Kvadrat	460800	\$74.10
Tonus Meadow by Kvadrat	466319	\$74.10
Toostripe	462260	\$164.26
Tracery	466372	\$87.69
Trait	464830	\$56.81
Transport	466176	\$119.80
Tread	466113	\$66.69

Treat	464510	\$67.93
Trees	466195	\$113.62
Trellis	466244	\$69.78
Trio	466088	\$93.86
Trundle	466434	\$38.29
Tuft	700004	\$29.64
Twice	465909	\$46.93
Unisol	461160	\$142.03
Urban	466079	\$61.75
Vases	466164	\$92.63
Velvet Stripe	466279	\$166.73
Venn	464360	\$62.99
Vestige	466259	\$62.99
Vineyard	466133	\$92.63
Voyage	456801	\$125.97
Waterborn by Kvadrat	466097	\$136.50
Wedge	466272	\$64.22
Wend	466381	\$46.93
Whirl	463800	\$46.93
Wool Rib	466198	\$113.62
Wool Striae	466184	\$170.43
Wool Velvet	466120	\$203.78
Wrap	466231	\$49.40

**Prose Seating**

Designed by Memo Studio, 2017

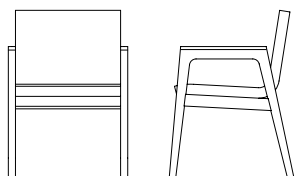

Depth	Width	Height
24"	23"	33"

Product	Code	List Price COM
Side Chair with Arms - Ash	GC01-10-A	\$1470
Side Chair with Arms - Walnut	GC01-10-W	\$2470

Textile Yardage	Seat	Back	Arms
Total: 1.75	n/a	n/a	n/a

For textile price (net), multiply required yardage by textile pricing on page 19.

**Standard with Core Product**

- Glides
- HR Polyurethane Foam
- Wood Arm Caps

Options	Code	List Price COM
Solid Surface Arm Caps, Grade 1	CAS	\$280
Solid Surface Arm Caps, Grade 2	CAP	\$560
Removable Covers	RC	\$170
Moisture Barrier	MB	\$170
CAL TB 133	FB	\$170
Linked End Table	LKE	(each) \$800
Linked Corner Table	LKC	(each) \$800
Linked Connecting Table	LCT	(each) \$600
Solid Surface Table Top, Grade 1	CTS	(each) \$340
Solid Surface Table Top, Grade 2	CTP	(each) \$680
Wood Table Top - Ash	WTA	(each) \$340
Wood Table Top - Walnut	WTW	(each) \$510
Stone/Quartz Table Top	ST	(each) \$650

Continues...

Continued...

**Specifiable Finishes**

Laminate  
Solid Surface  
Stone/Quartz  
Textiles  
Wood

**Reference Price Range**

List Price COM: \$1470-\$3540

**Notes**

To estimate product Net Price with Textiles, apply your discount to the List Price COM, and then add your Textile Price (yardage x textile pricing on page 19).

Pricing includes Freight within Continental US.

Available in custom widths per engineering and quote approval.

Due to its continuous seat and back, multiple fabric configurations are not supported on the Prose Side Chair.

Reference Price Range does not include optional Linked Tables.

Linked Tables standard in laminate.

For step-by-step specifications and quotes, access our live quote tool online at [memofurniture.com/quotes](http://memofurniture.com/quotes).

**Prose Seating**

Designed by Memo Studio, 2017

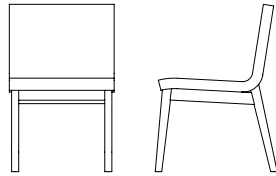

Depth	Width	Height
24"	20"	33"

Product	Code	List Price COM
Side Chair Armless - Ash	GC01-09-A	\$1370
Side Chair Armless - Walnut	GC01-09-W	\$2370

Textile Yardage	Seat	Back	Arms
Total: 1.75	n/a	n/a	n/a

For textile price (net), multiply required yardage by textile pricing on page 19.

**Standard with Core Product**

Glides  
HR Polyurethane Foam

Options	Code	List Price COM
Removable Covers	RC	\$170
Moisture Barrier	MB	\$170
CAL TB 133	FB	\$170
Linked End Table	LKE	(each) 800
Linked Corner Table	LKC	(each) \$800
Linked Connecting Table	LCT	(each) \$600
Solid Surface Table Top, Grade 1	CTS	(each) \$340
Solid Surface Table Top, Grade 2	CTP	(each) \$680
Wood Table Top - Ash	WTA	(each) \$340
Wood Table Top - Walnut	WTW	(each) \$510
Stone/Quartz Table Top	ST	(each) \$650

Continues...

Continued...

**Specifiable Finishes**

Laminate  
Solid Surface  
Stone/Quartz  
Textiles  
Wood

**Reference Price Range**

List Price COM: \$1370-\$2880

**Notes**

To estimate product Net Price with Textiles, apply your discount to the List Price COM, and then add your Textile Price (yardage x textile pricing on page 19).

Pricing includes Freight within Continental US.

Available in custom widths per engineering and quote approval.

Due to its continuous seat and back, multiple fabric configurations are not supported on the Prose Side Chair.

Reference Price Range does not include optional Linked Tables.

Linked Tables standard in laminate.

For step-by-step specifications and quotes, access our live quote tool online at [memofurniture.com/quotes](http://memofurniture.com/quotes).



**Prose Seating**

Designed by Memo Studio, 2017

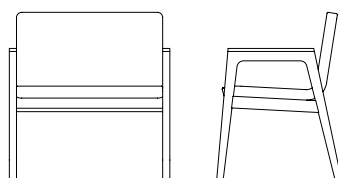

Depth	Width	Height
24"	30.75"	33"

Product	Code	List Price COM
Plus Chair - Ash	GC01-15-A	\$2050
Plus Chair - Walnut	GC01-15-W	\$3050

Textile Yardage	Seat	Back	Arms
Total: 2.25	n/a	n/a	n/a

For textile price (net), multiply required yardage by textile pricing on page 19.

**Standard with Core Product**

- Glides
- HR Polyurethane Foam
- Wood Arm Caps

Options	Code	List Price COM
Solid Surface Arm Caps, Grade 1	CAS	\$280
Solid Surface Arm Caps, Grade 2	CAP	\$560
Removable Covers	RC	\$170
Moisture Barrier	MB	\$170
CAL TB 133	FB	\$170
Linked End Table	LKE	(each) \$800
Linked Corner Table	LKC	(each) \$800
Linked Connecting Table	LCT	(each) \$600
Solid Surface Table Top, Grade 1	CTS	(each) \$340
Solid Surface Table Top, Grade 2	CTP	(each) \$680
Wood Table Top - Ash	WTA	(each) \$340
Wood Table Top - Walnut	WTW	(each) \$510
Stone/Quartz Table Top	ST	(each) \$650

Continues...

Continued...

**Specifiable Finishes**

Laminate  
Solid Surface  
Stone/Quartz  
Textiles  
Wood

**Reference Price Range**

List Price COM: \$2050–\$3120

**Notes**

To estimate product Net Price with Textiles, apply your discount to the List Price COM, and then add your Textile Price (yardage x textile pricing on page 19).

Pricing includes Freight within Continental US.

Available in custom widths per engineering and quote approval.

Due to its continuous seat and back, multiple fabric configurations are not supported on the Prose Plus Chair.

Reference Price Range does not include optional Linked Tables.

Linked Tables standard in laminate.

For step-by-step specifications and quotes, access our live quote tool online at [memofurniture.com/quotes](http://memofurniture.com/quotes).

**Prose Seating**

Designed by Memo Studio, 2017

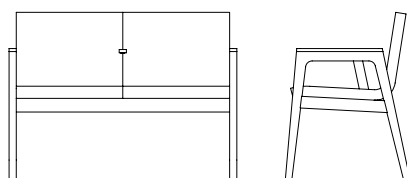

Depth	Width	Height
24"	43.5"	33"

Product	Code	List Price COM
Two Seat Tandem - Ash	GC01-20-A	\$2600
Two Seat Tandem - Walnut	GC01-20-W	\$3725

Textile Yardage	Seat	Back	Arms
Total: 3.5	n/a	n/a	n/a

For textile price (net), multiply required yardage by textile pricing on page 19.

**Standard with Core Product**

- Glides
- HR Polyurethane Foam
- Wood Arm Caps

Options	Code	List Price COM
Intermediate Arm (wood)	IA	\$350
Solid Surface Arm Caps, Grade 1	CAS	\$280
Solid Surface Arm Caps, Grade 2	CAP	\$560
Removable Covers	RC	\$170
Moisture Barrier	MB	\$170
CAL TB 133	FB	\$170
In-Line Table	INL	(each) \$600
Linked End Table	LKE	(each) \$800
Linked Corner Table	LKC	(each) \$800
Linked Connecting Table	LCT	(each) \$600
Solid Surface Table Top, Grade 1	CTS	(each) \$340
Solid Surface Table Top, Grade 2	CTP	(each) \$680
Wood Table Top - Ash	WTA	(each) \$340
Wood Table Top - Walnut	WTW	(each) \$510
Stone/Quartz Table Top	ST	(each) \$650

Continued...

**Specifiable Finishes**

Laminate  
Solid Surface  
Stone/Quartz  
Textiles  
Wood

**Reference Price Range**

List Price COM: \$2600-\$7715

**Notes**

To estimate product Net Price with Textiles, apply your discount to the List Price COM, and then add your Textile Price (yardage x textile pricing on page 19).

Pricing includes Freight within Continental US.

Available with or without intermediate arms.

Due to its continuous seat and back, multiple fabric configurations are not supported on the Prose Two Seat Tandem.

Reference Price Range does not include optional Linked Tables.

Linked Tables standard in laminate.

For step-by-step specifications and quotes, access our live quote tool online at [memofurniture.com/quotes](http://memofurniture.com/quotes).

**Prose Seating**

Designed by Memo Studio, 2017

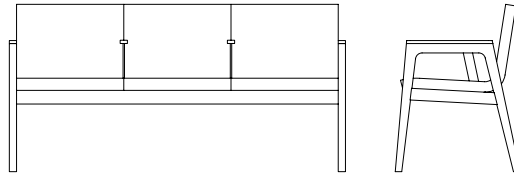

Depth	Width	Height
24"	64"	33"

Product	Code	List Price COM
Three Seat Tandem - Ash	GC01-30-A	\$3650
Three Seat Tandem - Walnut	GC01-30-W	\$4900

Textile Yardage	Seat	Back	Arms
Total: 5.25	n/a	n/a	n/a

For textile price (net), multiply required yardage by textile pricing on page 19.

**Standard with Core Product**

- Glides
- HR Polyurethane Foam
- Wood Arm Caps

Options	Code	List Price COM
Intermediate Arms (wood)	IA	(each) \$350
Solid Surface Arm Caps, Grade 1	CAS	\$280
Solid Surface Arm Caps, Grade 2	CAP	\$560
Removable Covers	RC	\$170
Moisture Barrier	MB	\$170
CAL TB 133	FB	\$170
In-Line Table	INL	(each) \$600
Linked End Table	LKE	(each) \$800
Linked Corner Table	LKC	(each) \$800
Linked Connecting Table	LCT	(each) \$600
Solid Surface Table Top, Grade 1	CTS	(each) \$340
Solid Surface Table Top, Grade 2	CTP	(each) \$680
Wood Table Top - Ash	WTA	(each) \$340
Wood Table Top - Walnut	WTW	(each) \$510
Stone/Quartz Table Top	ST	(each) \$650

Continued...

**Specifiable Finishes**

Laminate  
Solid Surface  
Stone/Quartz  
Textiles  
Wood

**Reference Price Range**

List Price COM: \$3650–\$7940

**Notes**

To estimate product Net Price with Textiles, apply your discount to the List Price COM, and then add your Textile Price (yardage x textile pricing on page 19).

Pricing includes Freight within Continental US.

Available with or without intermediate arms.

Due to its continuous seat and back, multiple fabric configurations are not supported on the Prose Three Seat Tandem.

Reference Price Range does not include optional Linked Tables.

Linked Tables standard in laminate.

For step-by-step specifications and quotes, access our live quote tool online at [memofurniture.com/quotes](http://memofurniture.com/quotes).

**Prose Seating**

Designed by Memo Studio, 2017

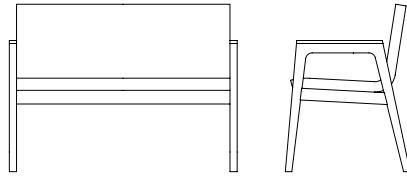

Depth	Width	Height
24"	43.5"	33"

Product	Code	List Price COM
Settee - Ash	GC01-22-A	\$2600
Settee - Walnut	GC01-22-W	\$3600

Textile Yardage	Seat	Back	Arms
Total: 3.25	n/a	n/a	n/a

For textile price (net), multiply required yardage by textile pricing on page 19.

**Standard with Core Product**

- Glides
- HR Polyurethane Foam
- Wood Arm Caps

Options	Code	List Price COM
Solid Surface Arm Caps, Grade 1	CAS	\$280
Solid Surface Arm Caps, Grade 2	CAP	\$560
Removable Covers	RC	\$170
Moisture Barrier	MB	\$170
CAL TB 133	FB	\$170
Linked End Table	LKE	(each) \$800
Linked Corner Table	LKC	(each) \$800
Linked Connecting Table	LCT	(each) \$600
Solid Surface Table Top, Grade 1	CTS	(each) \$340
Solid Surface Table Top, Grade 2	CTP	(each) \$680
Wood Table Top - Ash	WTA	(each) \$340
Wood Table Top - Walnut	WTW	(each) \$510
Stone/Quartz Table Top	ST	(each) \$650

Continues...

Continued...

**Specifiable Finishes**

Laminate  
Solid Surface  
Stone/Quartz  
Textiles  
Wood

**Reference Price Range**

List Price COM: \$2600-\$4670

**Notes**

To estimate product Net Price with Textiles, apply your discount to the List Price COM, and then add your Textile Price (yardage x textile pricing on page 19).

Pricing includes Freight within Continental US.

Available in custom widths per engineering and quote approval.

Due to its continuous seat and back, multiple fabric configurations are not supported on the Prose Settee.

Reference Price Range does not include optional Linked Tables.

Linked Tables standard in laminate.

For step-by-step specifications and quotes, access our live quote tool online at [memofurniture.com/quotes](http://memofurniture.com/quotes).



**Prose Seating**

Designed by Memo Studio, 2017

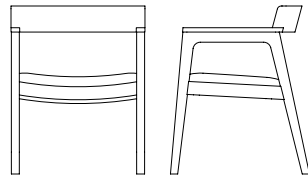

Depth	Width	Height
24"	23"	29.5"

Product	Code	List Price COM
Pull-Up Chair - Ash	GC01-11-A	\$1690
Pull-Up Chair - Walnut	GC01-11-W	\$2690

Textile Yardage	Seat	Back	Arms
Total: 1.0	1.0	n/a	n/a

For textile price (net), multiply required yardage by textile pricing on page 19.

**Standard with Core Product**

- Glides
- HR Polyurethane Foam
- Wood Arm Caps

Options	Code	List Price COM
Removable Covers	RC	\$170
Moisture Barrier	MB	\$170
CAL TB 133	FB	\$170

**Specifiable Finishes**

- Textiles
- Wood

**Reference Price Range**

List Price COM: \$1690–\$3200

Continues...

Continued...

**Notes**

To estimate product Net Price with Textiles, apply your discount to the List Price COM, and then add your Textile Price (yardage x textile pricing on page 19).

Pricing includes Freight within Continental US.

For step-by-step specifications and quotes, access our live quote tool online at [memofurniture.com/quotes](http://memofurniture.com/quotes).

**Prose Seating**

Designed by Memo Studio, 2017

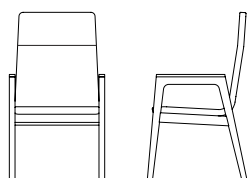

Depth	Width	Height
24"	23"	42.75"

Product	Code	List Price COM
High Back Chair - Ash	GC01-12-A	\$1690
High Back Chair - Walnut	GC01-12-W	\$2690

Textile Yardage	Seat	Back	Arms
Total: 2.0	n/a	n/a	n/a

For textile price (net), multiply required yardage by textile pricing on page 19.

**Standard with Core Product**

HR Polyurethane Foam  
Wood Arm Caps  
Glides

Options	Code	List Price COM
Solid Surface Arm Caps, Grade 1	CAS	\$280
Solid Surface Arm Caps, Grade 2	CAP	\$560
Removable Covers	RC	\$170
Moisture Barrier	MB	\$170
CAL TB 133	FB	\$170

**Specifiable Finishes**

Solid Surface  
Textiles  
Wood

**Reference Price Range**

List Price COM: \$1690-\$3760

Continues...

Continued...

**Notes**

To estimate product Net Price with Textiles, apply your discount to the List Price COM, and then add your Textile Price (yardage x textile pricing on page 19).

Pricing includes Freight within Continental US.

Available in custom widths per engineering and quote approval.

Due to its continuous seat and back, multiple fabric configurations are not supported on the Prose High Back Chair.

For step-by-step specifications and quotes, access our live quote tool online at [memofurniture.com/quotes](http://memofurniture.com/quotes).

**Prose Seating**

Designed by Memo Studio, 2017

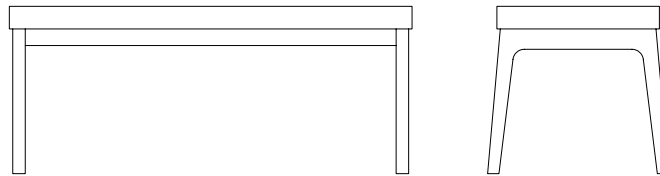

Depth	Width	Height
20"	43.5"	18.5"

Product	Code	List Price COM
Bench - Ash	GC01-07-A	\$1600
Bench - Walnut	GC01-07-W	\$2600

Textile Yardage	Seat	Back	Arms
Total: 1.5	n/a	n/a	n/a

For textile price (net), multiply required yardage by textile pricing on page 19.

**Standard with Core Product**

Glides  
HR Polyurethane Foam

Options	Code	List Price COM
Removable Covers	RC	\$170
Moisture Barrier	MB	\$170
CAL TB 133	FB	\$170

**Specifiable Finishes**

Textiles  
Wood

**Reference Price Range**

List Price COM: \$1690-\$3110

Continued...

**Notes**

To estimate product Net Price with Textiles, apply your discount to the List Price COM, and then add your Textile Price (yardage x textile pricing on page 19).

Pricing includes Freight within Continental US.

Available in custom widths per engineering and quote approval.

For step-by-step specifications and quotes, access our live quote tool online at [memofurniture.com/quotes](http://memofurniture.com/quotes).

**Prose Seating**

Designed by Memo Studio, 2017

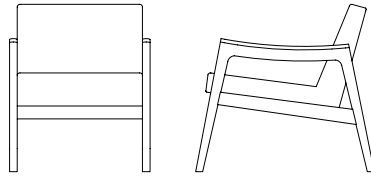

Depth	Width	Height
32"	25.5"	30"

Product	Code	List Price COM
Lounge - Ash	GC01-01-A	\$2900
Lounge - Walnut	GC01-01-W	\$3900

Textile Yardage	Seat	Back	Arms
Total: 3.0	1.5	1.5	n/a

For textile price (net), multiply required yardage by textile pricing on page 19.

**Standard with Core Product**

- Glides
- HR Polyurethane Foam
- Wood Arm Caps

Options	Code	List Price COM
Solid Surface Arms Caps, Grade 1	CAS	\$280
Solid Surface Arms Caps, Grade 2	CAP	\$560
Removable Covers	RC	\$170
Moisture Barrier	MB	\$170
CAL TB 133	FB	\$170
Multiple Textiles (Seat/Back)	TA	\$100

**Specifiable Finishes**

- Solid Surface
- Textiles
- Wood

Continues...

Continued...

**Reference Price Range**

List Price COM: \$2900–\$5070

**Notes**

To estimate product Net Price with Textiles, apply your discount to the List Price COM, and then add your Textile Price (yardage x textile pricing on page 19).

Available in custom widths per engineering and quote approval.

Multiple fabric option allows for separate seat and back textiles.

Pricing includes Freight within Continental US.

For step-by-step specifications and quotes, access our live quote tool online at [memofurniture.com/quotes](http://memofurniture.com/quotes).



**Prose Seating**

Designed by Memo Studio, 2017

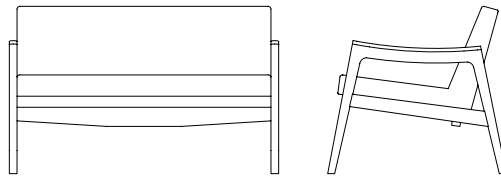

Depth	Width	Height
32"	48"	30"

Product	Code	List Price COM
Loveseat - Ash	GC01-02-A	\$4800
Loveseat - Walnut	GC01-02-W	\$5800

Textile Yardage	Seat	Back	Arms
Total: 6.0	3.0	3.0	n/a

For textile price (net), multiply required yardage by textile pricing on page 19.

**Standard with Core Product**

- Glides
- HR Polyurethane Foam
- Wood Arm Caps

Options	Code	List Price COM
Solid Surface Arms Caps, Grade 1	CAS	\$280
Solid Surface Arms Caps, Grade 2	CAP	\$560
Removable Covers	RC	\$170
Moisture Barrier	MB	\$170
CAL TB 133	FB	\$170
Multiple Textiles (Seat/Back)	TA	\$100

**Specifiable Finishes**

- Solid Surface
- Textiles
- Wood

Continues...

Continued...

**Reference Price Range**

List Price COM: \$4800–\$6970

**Notes**

To estimate product Net Price with Textiles, apply your discount to the List Price COM, and then add your Textile Price (yardage x textile pricing on page 19).

Available in custom widths per engineering and quote approval.

Multiple fabric option allows for separate seat and back textiles.

Pricing includes Freight within Continental US.

For step-by-step specifications and quotes, access our live quote tool online at [memofurniture.com/quotes](http://memofurniture.com/quotes).

**Prose Seating**

Designed by Memo Studio, 2017

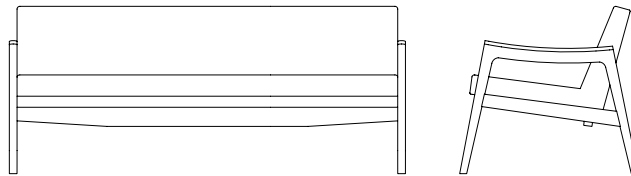

Depth	Width	Height
32"	59.25"	30"

Product	Code	List Price COM
Sofa - Ash	GC01-03-A	\$5700
Sofa - Walnut	GC01-03-W	\$6700

Textile Yardage	Seat	Back	Arms
Total: 8.5	4.25	4.25	n/a

For textile price (net), multiply required yardage by textile pricing on page 19.

**Standard with Core Product**

- Glides
- HR Polyurethane Foam
- Wood Arm Caps

Options	Code	List Price COM
Solid Surface Arms Caps, Grade 1	CAS	\$280
Solid Surface Arms Caps, Grade 2	CAP	\$560
Removable Covers	RC	\$170
Moisture Barrier	MB	\$170
CAL TB 133	FB	\$170
Multiple Textiles (Seat/Back)	TA	\$100

**Specifiable Finishes**

- Solid Surface
- Textiles
- Wood

Continues...

Continued...

**Reference Price Range**

List Price COM: \$5700–\$7870

**Notes**

To estimate product Net Price with Textiles, apply your discount to the List Price COM, and then add your Textile Price (yardage x textile pricing on page 19).

Available in custom widths per engineering and quote approval.

Multiple fabric option allows for separate seat and back textiles.

Pricing includes Freight within Continental US.

For step-by-step specifications and quotes, access our live quote tool online at [memofurniture.com/quotes](http://memofurniture.com/quotes).

**Prose Seating**

Designed by Memo Studio, 2017

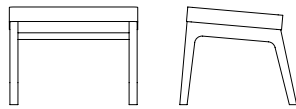

Depth	Width	Height
20"	21.5"	17"

Product	Code	List Price COM
Ottoman - Ash	GC01-00-A	\$1070
Ottoman - Walnut	GC01-00-W	\$1695

Textile Yardage	Seat	Back	Arms
Total: 1.0	n/a	n/a	n/a

For textile price (net), multiply required yardage by textile pricing on page 19.

**Standard with Core Product**

Glides  
HR Polyurethane Foam

Options	Code	List Price COM
Removable Covers	RC	\$170
Moisture Barrier	MB	\$170
CAL TB 133	FB	\$170

**Specifiable Finishes**

Textiles  
Wood

**Reference Price Range**

List Price COM: \$1070-\$2205

Continued...

**Notes**

To estimate product Net Price with Textiles, apply your discount to the List Price COM, and then add your Textile Price (yardage x textile pricing on page 19).

Pricing includes Freight within Continental US.

Designed to be used with the Prose Lounge Chair.

For step-by-step specifications and quotes, access our live quote tool online at [memofurniture.com/quotes](http://memofurniture.com/quotes).

**Prose Seating**

Designed by Memo Studio, 2017

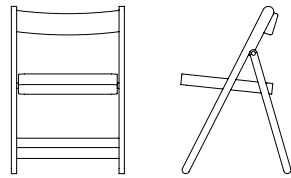

Depth	Width	Height
22"	21.5"	31"

Product	Code	List Price COM
Folding Chair - Ash	GC01-08-A	\$740
Folding Chair - Walnut	GC01-08-W	\$1240

Textile Yardage	Seat	Back	Arms
Total: 1.0	n/a	n/a	n/a

For textile price (net), multiply required yardage by textile pricing on page 19.

**Standard with Core Product**

HR Polyurethane Foam  
Stainless Steel Hinges  
Glides

Options	Code	List Price COM
Moisture Barrier	MB	\$170
CAL TB 133	FB	\$170
Hanging Fixture	DJ	\$350

**Specifiable Finishes**

Textiles  
Wood

**Reference Price Range**

List Price COM: \$740–\$1930

Continues...

Continued...

**Notes**

To estimate product Net Price with Textiles, apply your discount to the List Price COM, and then add your Textile Price (yardage x textile pricing on page 19).

Pricing includes Freight within Continental US.

For step-by-step specifications and quotes, access our live quote tool online at [memofurniture.com/quotes](http://memofurniture.com/quotes).



**Prose Tables**

Designed by Memo Studio, 2017

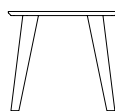

Depth	Width	Height
20"	20"	18.5"

Product	Code	List Price COM
Free-Stndng End Table-Ash	GC01-T1-A	\$1400
Free-Stndng End Table-Walnut	GC01-T1-W	\$2100

**Standard with Core Product**

Glides  
Laminate Top

Options	Code	List Price COM
Solid Surface Top, Grade 1	CTS	\$340
Solid Surface Top, Grade 2	CTP	\$680
Wood Top - Ash	WTA	\$340
Wood Top - Walnut	WTW	\$510
Stone/Quartz Top	ST	\$650

**Specifiable Finishes**

Laminate  
Solid Surface  
Stone/Quartz  
Wood

**Reference Price Range**

List Price COM: \$1400-\$2780

**Notes**

Pricing includes Freight within Continental US.

For step-by-step specifications and quotes, access our live quote tool online at [memofurniture.com/quotes](http://memofurniture.com/quotes).

**Prose Tables**

Designed by Memo Studio, 2017

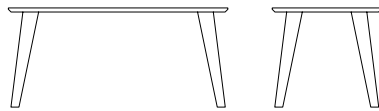

Depth	Width	Height
20"	40"	18.5"

Product	Code	List Price COM
Free-Stndng Coff. Table-Ash	GC01-T2-A	\$1900
Free-Stndng Coff. Table-Walnut	GC01-T2-W	\$2600

**Standard with Core Product**

Glides  
Laminate Top

Options	Code	List Price COM
Solid Surface Top, Grade 1	CTS	\$340
Solid Surface Top, Grade 2	CTP	\$680
Wood Top - Ash	WTA	\$340
Wood Top - Walnut	WTW	\$510
Stone/Quartz Top	ST	\$650

**Specifiable Finishes**

Laminate  
Solid Surface  
Stone/Quartz  
Wood

**Reference Price Range**

List Price COM: \$1900-\$3280

**Notes**

Pricing includes Freight within Continental US.

For step-by-step specifications and quotes, access our live quote tool online at [memofurniture.com/quotes](http://memofurniture.com/quotes).

**Tenet**

Designed by George Simons Jr., 2017

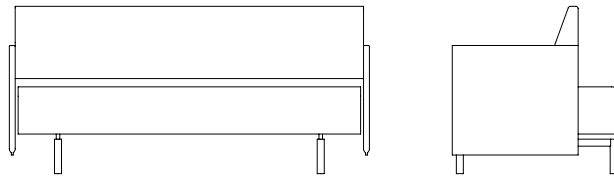

Depth	Width	Height
36"	77"	35.5"

Product	Code	List Price COM
Daybed - Low Arms	GS01-37-LA	\$6800
Daybed - Mid Arms	GS01-37-MA	\$7140
Daybed - High Arms	GS01-37-HA	\$7250

Textile Yardage	Seat	Back	Arms
Low Arms - Total: 7.25	3.0	2.25	2.0
Mid Arms - Total: 9.5	3.0	2.25	4.25
High Arms - Total: 10.75	3.0	2.25	5.5

For textile price (net), multiply required yardage by textile pricing on page 19.

**Standard with Core Product**

- HR Polyurethane Foam
- Non-Marring Glides
- Powder Coated Metal Legs
- Proprietary Sliding Mechanism

Options	Code	List Price COM
Wood Legs	LW	\$350
Casters	CS	\$340
Removeable Arm Pads	AP	(pair) \$330
Removeable Covers	RC	\$280
Moisture Barrier	MB	\$340
CAL TB 133	FB	\$1000
Mult. Textile (Arm 1, Seat/Back 2)	AT	\$100
Mult. Textile (Seat 1, Arm/Back 2)	ST	\$100
Mult. Textile (Back 1, Arm/Seat 2)	BT	\$100

Continues...

Continued...

**Specifiable Finishes**

Leather

Metal

Textiles

Wood

**Reference Price Range**

List Price COM: \$6800–\$10440

**Notes**

To estimate product Net Price with Textiles, apply your discount to the List Price COM, and then add your Textile Price (yardage x textile pricing on page 19).

Pricing includes Freight within Continental US.

For step-by-step specifications and quotes, access our live quote tool online at [memofurniture.com/quotes](http://memofurniture.com/quotes).

**Array Casework**

Designed by George Simons Jr., 2017

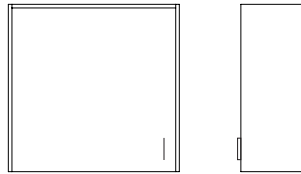

Depth	Width	Height
8.75"	23.5"	23.25"

Product	Code	List Price COM
Overhead Storage w/doors-sgl.	GS02-U1	\$1400

**Standard with Core Product**

- Approved HPL Doors
- Approved HPL Outer Case Wrap
- Door Pulls
- Soft Close Hinges
- White Melamine Carcass

**Laminates (HPL)**

For a list of approved HPL products see page 09. Non-approved HPL products will be priced on a case-by-case basis.

Options	Code	List Price COM
Bow Pull	P1	--
Tab Pull	P2	--
Straight Pull	P3	--
Glove Cut Outs (group of 3)	GH	\$110
Veneer Outer Case	VC	\$500

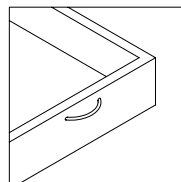

Bow Pull

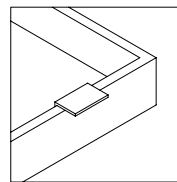

Tab Pull

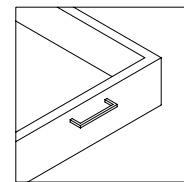

Straight Pull

Continues...

Continued...

**Specifiable Finishes**

Laminate (HPL)

Veneer

**Reference Price Range**

List Price COM: \$1400-\$2010

**Notes**

Doors can be specified hinge-right or hinge-left during quote process.

Pricing includes Freight within Continental US.

Customized sizes available upon request and subject to price increases.

Case wrap can be specified as full, open left, open right, or open both sides.

All pulls standard in Brushed Nickel.

For step-by-step specifications and quotes, access our live quote tool online at [memofurniture.com/quotes](http://memofurniture.com/quotes).

**Array Casework**

Designed by George Simons Jr., 2017



Depth	Width	Height
8.75"	46.25"	23.25"

Product	Code	List Price COM
Overhead Storage w/doors-dbl.	GS02-U2	\$2400

**Standard with Core Product**

- Approved HPL Doors
- Approved HPL Outer Case Wrap
- Door Pulls
- Soft Close Hinges
- White Melamine Carcass

**Laminates (HPL)**

For a list of approved HPL products see page 09. Non-approved HPL products will be priced on a case-by-case basis.

Options	Code	List Price COM
Bow Pull	P1	--
Tab Pull	P2	--
Straight Pull	P3	--
Glove Cut Outs (group of 3)	GH	\$110
Veneer Outer Case	VC	\$650

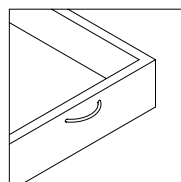

Bow Pull

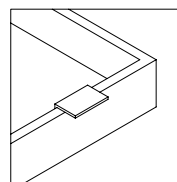

Tab Pull

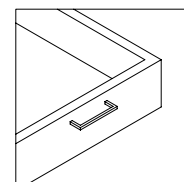

Straight Pull

Continues..

Continued...

**Specifiable Finishes**

Laminate (HPL)

Veneer

**Reference Price Range**

List Price COM: \$2400–\$3160

**Notes**

Doors can be specified hinge-right or hinge-left during quote process.

Pricing includes Freight within Continental US.

Customized sizes available upon request and subject to price increases.

Case wrap can be specified as full, open left, open right, or open both sides.

All pulls standard in Brushed Nickel.

For step-by-step specifications and quotes, access our live quote tool online at [memofurniture.com/quotes](http://memofurniture.com/quotes).



**Array Casework**

Designed by George Simons Jr., 2017

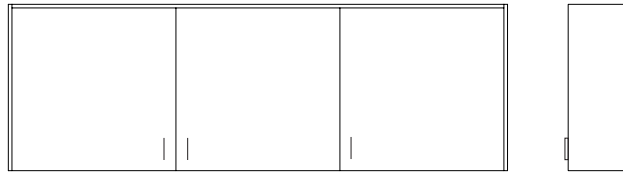

**Depth**    **Width**    **Height**  
8.75"       70"       23.25"

<b>Product</b>	<b>Code</b>	<b>List Price COM</b>
Overhead Storage w/doors-trpl.	GS02-U3	\$3200

**Standard with Core Product**

- Approved HPL Doors
- Approved HPL Outer Case Wrap
- Door Pulls
- Soft Close Hinges
- White Melamine Carcass

**Laminates (HPL)**

For a list of approved HPL products see page 09. Non-approved HPL products will be priced on a case-by-case basis.

<b>Options</b>	<b>Code</b>	<b>List Price COM</b>
Bow Pull	P1	--
Tab Pull	P2	--
Straight Pull	P3	--
Glove Cut Outs (group of 3)	GH	\$110
Veneer Outer Case	VC	\$750

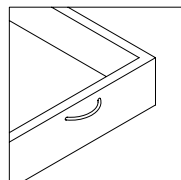

Bow Pull

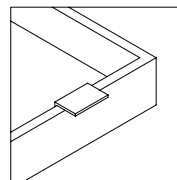

Tab Pull

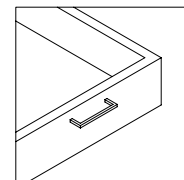

Straight Pull

Continues..

Continued...

**Specifiable Finishes**

Laminate (HPL)

Veneer

**Reference Price Range**

List Price COM: \$3200–\$4060

**Notes**

Doors can be specified hinge-right or hinge-left during quote process.

Pricing includes Freight within Continental US.

Customized sizes available upon request and subject to price increases.

Case wrap can be specified as full, open left, open right, or open both sides.

All pulls standard in Brushed Nickel.

For step-by-step specifications and quotes, access our live quote tool online at [memofurniture.com/quotes](http://memofurniture.com/quotes).

**Array Casework**

Designed by George Simons Jr., 2017

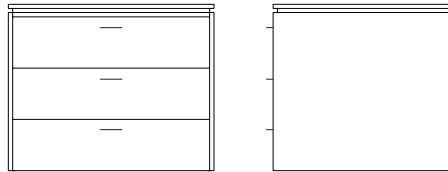

**Depth**    **Width**    **Height**  
20.75"    23.5"    19.25"

<b>Product</b>	<b>Code</b>	<b>List Price COM</b>
Drawer Module - Single	GS02-D1	\$3200

**Standard with Core Product**

- Approved HPL Outer Case Wrap
- Approved HPL Drawers
- Drawer Pulls
- Soft Close Drawers
- Solid Surface Top (Grade 1)
- White Melamine Carcass

**Laminates (HPL)**

For a list of approved HPL products see page 09. Non-approved HPL products will be priced on a case-by-case basis.

<b>Options</b>	<b>Code</b>	<b>List Price COM</b>
Bow Pull	P1	--
Tab Pull	P2	--
Straight Pull	P3	--
Drawer Liners	DL	\$100
Veneer Outer Case	VC	\$400
Solid Surface (Grade 2)	CTP	\$460

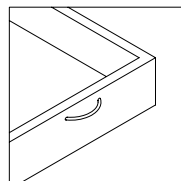

Bow Pull

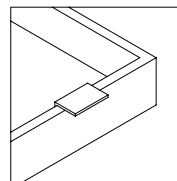

Tab Pull

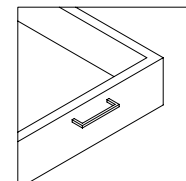

Straight Pull

Continued...

**Specifiable Finishes**

Laminate (HPL)  
Solid Surface  
Veneer

**Reference Price Range**

List Price COM: \$3200–\$4160

**Notes**

Pricing includes Freight within Continental US.

Customized sizes available upon request and subject to price increases.

Case wrap can be specified as full, open left, open right, or open both sides.

All pulls standard in Brushed Nickel.

For step-by-step specifications and quotes, access our live quote tool online at [memofurniture.com/quotes](http://memofurniture.com/quotes).

**Array Casework**

Designed by George Simons Jr., 2017

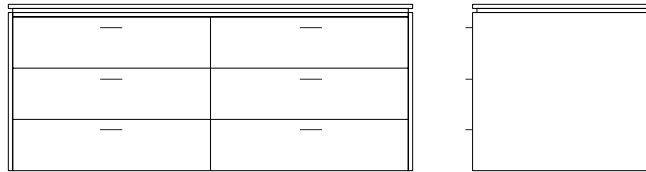

**Depth**    **Width**    **Height**  
20.75"    46.25"    19.25"

<b>Product</b>	<b>Code</b>	<b>List Price COM</b>
Drawer Module - Double	GS02-D2	\$5500

**Standard with Core Product**

- Approved HPL Outer Case Wrap
- Approved HPL Drawers
- Drawer Pulls
- Soft Close Drawers
- Solid Surface Top (Grade 1)
- White Melamine Carcass

**Laminates (HPL)**

For a list of approved HPL products see page 09. Non-approved HPL products will be priced on a case-by-case basis.

<b>Options</b>	<b>Code</b>	<b>List Price COM</b>
Bow Pull	P1	--
Tab Pull	P2	--
Straight Pull	P3	--
Drawer Liners	DL	\$100
Veneer Outer Case	VC	\$400
Solid Surface (Grade 2)	CTP	\$560

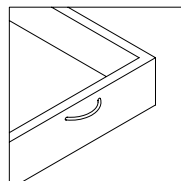

Bow Pull

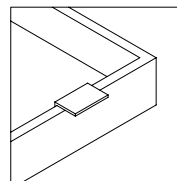

Tab Pull

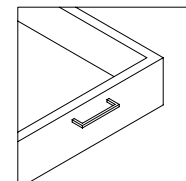

Straight Pull

Continued...

**Specifiable Finishes**

Laminate (HPL)  
Solid Surface  
Veneer

**Reference Price Range**

List Price COM: \$5500–\$6560

**Notes**

Pricing includes Freight within Continental US.

Customized sizes available upon request and subject to price increases.

Case wrap can be specified as full, open left, open right, or open both sides.

All pulls standard in Brushed Nickel.

For step-by-step specifications and quotes, access our live quote tool online at [memofurniture.com/quotes](http://memofurniture.com/quotes).

**Array Casework**

Designed by George Simons Jr., 2017

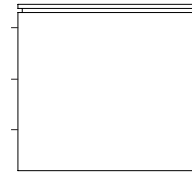

**Depth**    **Width**    **Height**  
20.75"    70"    19.25"

<b>Product</b>	<b>Code</b>	<b>List Price COM</b>
Drawer Module - Triple	GS02-D3	\$7500

**Standard with Core Product**

- Approved HPL Outer Case Wrap
- Approved HPL Drawers
- Drawer Pulls
- Soft Close Drawers
- Solid Surface Top (Grade 1)
- White Melamine Carcass

**Laminates (HPL)**

For a list of approved HPL products see page 09. Non-approved HPL products will be priced on a case-by-case basis.

<b>Options</b>	<b>Code</b>	<b>List Price COM</b>
Bow Pull	P1	--
Tab Pull	P2	--
Straight Pull	P3	--
Drawer Liners	DL	\$100
Veneer Outer Case	VC	\$400
Solid Surface (Grade 2)	CTP	\$660

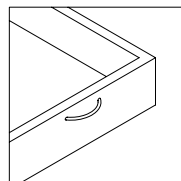

Bow Pull

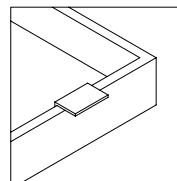

Tab Pull

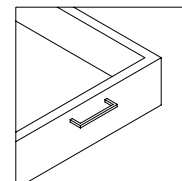

Straight Pull

Continued...

**Specifiable Finishes**

Laminate (HPL)  
Solid Surface  
Veneer

**Reference Price Range**

List Price COM: \$7500–\$9160

**Notes**

Pricing includes Freight within Continental US.

Customized sizes available upon request and subject to price increases.

Case wrap can be specified as full, open left, open right, or open both sides.

All pulls standard in Brushed Nickel.

For step-by-step specifications and quotes, access our live quote tool online at [memofurniture.com/quotes](http://memofurniture.com/quotes).



**Array Casework**

Designed by George Simons Jr., 2017

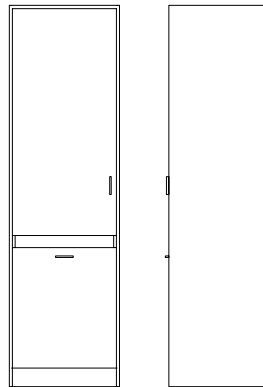

**Depth**    **Width**    **Height**  
20.75"    23.5"    80.75"

<b>Product</b>	<b>Code</b>	<b>List Price COM</b>
Wardrobe, Floor Based	GS02-WF	\$4200

**Standard with Core Product**  
Approved HPL Outer Case Wrap  
Approved HPL Doors and Drawers  
Door and Drawer Pulls  
Soft Close Hardware  
White Melamine Carcass

**Laminates (HPL)**  
For a list of approved HPL products see page 09. Non-approved HPL products will be priced on a case-by-case basis.

<b>Options</b>	<b>Code</b>	<b>List Price COM</b>
Bow Pull	P1	--
Tab Pull	P2	--
Straight Pull	P3	--
Veneer Outer Case	VC	\$750

Continues..

Continued...

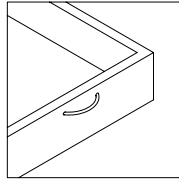

Bow Pull

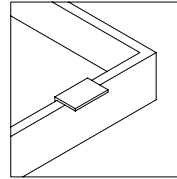

Tab Pull

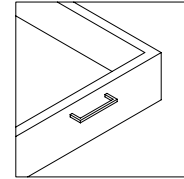

Straight Pull

**Specifiable Finishes**

Laminate (HPL)

Veneer

**Reference Price Range**

List Price COM: \$4200-\$4950

**Notes**

Pricing includes Freight within Continental US.

Customized sizes available upon request and subject to price increases.

All pulls standard in Brushed Nickel.

For step-by-step specifications and quotes, access our live quote tool online at [memofurniture.com/quotes](http://memofurniture.com/quotes).

**Array Casework**

Designed by George Simons Jr., 2017

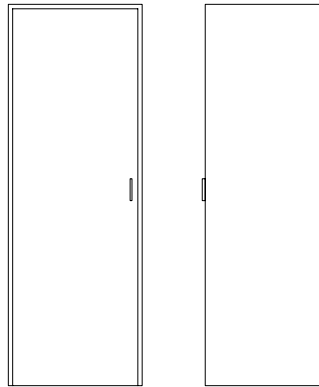

<b>Depth</b>	<b>Width</b>	<b>Height</b>
20.75"	23.5"	66.75"

<b>Product</b>	<b>Code</b>	<b>List Price COM</b>
Wardrobe, Wall Mounted - Basic	GS02-W1	\$2800

**Standard with Core Product**

- Approved HPL Outer Case Wrap
- Approved HPL Doors and Drawers
- Door and Drawer Pulls
- Soft Close Hardware
- White Melamine Carcass

**Laminates (HPL)**

For a list of approved HPL products see page 09. Non-approved HPL products will be priced on a case-by-case basis.

<b>Options</b>	<b>Code</b>	<b>List Price COM</b>
Bow Pull	P1	--
Tab Pull	P2	--
Straight Pull	P3	--
Veneer Outer Case	VC	\$750

Continues...

Continued...

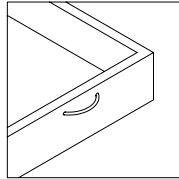

Bow Pull

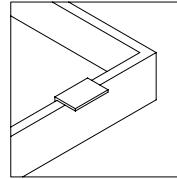

Tab Pull

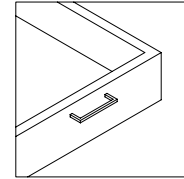

Straight Pull

**Specifiable Finishes**

Laminate (HPL)

Veneer

**Reference Price Range**

List Price COM: \$2800–\$3550

**Notes**

Pricing includes Freight within Continental US.

Customized sizes available upon request and subject to price increases.

All pulls standard in Brushed Nickel.

For step-by-step specifications and quotes, access our live quote tool online at [memofurniture.com/quotes](http://memofurniture.com/quotes).

**Array Casework**

Designed by George Simons Jr., 2017

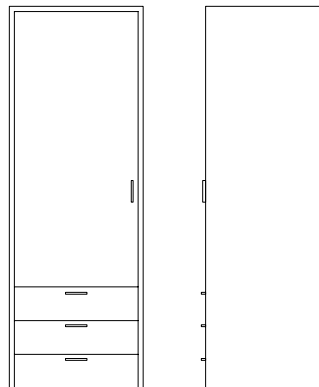

**Depth**    **Width**    **Height**  
20.75"    23.5"    66.75"

<b>Product</b>	<b>Code</b>	<b>List Price COM</b>
Wardrobe, Wall Mounted - Low	GS02-W2	\$4200

**Standard with Core Product**

- Approved HPL Outer Case Wrap
- Approved HPL Doors and Drawers
- Door and Drawer Pulls
- Soft Close Hardware
- White Melamine Carcass

**Laminates (HPL)**

For a list of approved HPL products see page 09. Non-approved HPL products will be priced on a case-by-case basis.

<b>Options</b>	<b>Code</b>	<b>List Price COM</b>
Bow Pull	P1	--
Tab Pull	P2	--
Straight Pull	P3	--
Drawer Liners	DL	\$100
Veneer Outer Case	VC	\$750

Continues..

Continued...

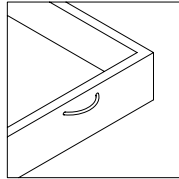

Bow Pull

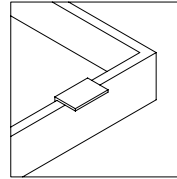

Tab Pull

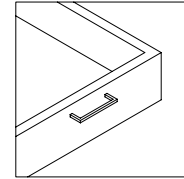

Straight Pull

**Specifiable Finishes**

Laminate (HPL)

Veneer

**Reference Price Range**

List Price COM: \$4200-\$4950

**Notes**

Pricing includes Freight within Continental US.

Customized sizes available upon request and subject to price increases.

All pulls standard in Brushed Nickel.

For step-by-step specifications and quotes, access our live quote tool online at [memofurniture.com/quotes](http://memofurniture.com/quotes).

**Array Work Stations**

Designed by George Simons Jr., 2017

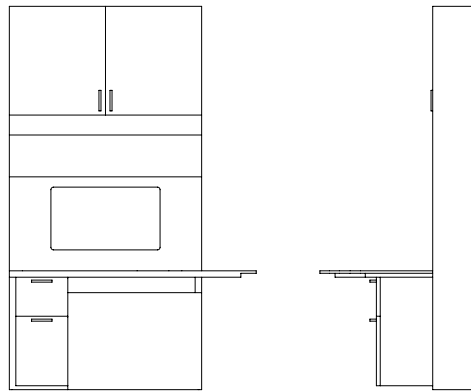

Depth	Width	Height
30.75"	47.5"	73.25"

Product	Code	List Price COM
Compact Work Station - LSF	GS02-W2-LSF	\$5800
Compact Work Station - RSF	GS02-W2-RSF	\$5800

**Standard with Core Product**

- Approved HPL Outer Case Wrap
- Approved HPL Doors and Drawers
- Door and Drawer Pulls
- Soft Close Hardware
- Solid Surface (Grade 1)
- White Melamine Carcass

**Laminates (HPL)**

For a list of approved HPL products see page 09. Non-approved HPL products will be priced on a case-by-case basis.

Options	Code	List Price COM
Bow Pull	P1	--
Tab Pull	P2	--
Straight Pull	P3	--
File Holders	FH	\$45

Continues...

**Options** continued...

Monitor Mounting Arm	MM	\$680
Veneer Outer Case	VC	\$750
Solid Surface (Grade 2)	CTP	\$360

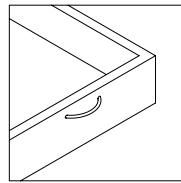

Bow Pull

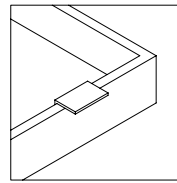

Tab Pull

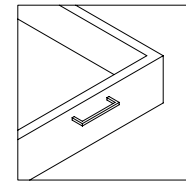

Straight Pull

**Specifiable Finishes**

- Laminate (HPL)
- Solid Surface
- Veneer

**Reference Price Range**

List Price COM: \$5800-\$7635

**Notes**

Pricing includes Freight within Continental US.

Customized sizes available upon request and subject to price increases.

All pulls standard in Brushed Nickel.

For step-by-step specifications and quotes, access our live quote tool online at [memofurniture.com/quotes](http://memofurniture.com/quotes).



**Array Sink Stations**

Designed by George Simons Jr., 2017

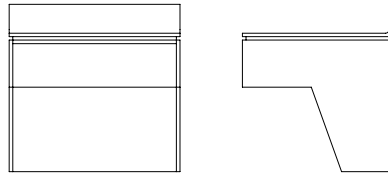

Depth	Width	Height
20.75"	23.5"	19.25"

Product	Code	List Price COM
Sink	GS02-S1	\$10000

**Standard with Core Product**

Approved HPL Outer Case Wrap  
Solid Surface Sink and Backsplash (Grade 1)  
White Melamine Carcass

**Laminates (HPL)**

For a list of approved HPL products see page 09. Non-approved HPL products will be priced on a case-by-case basis.

Options	Code	List Price COM
Veneer Outer Case	VC	\$400
Solid Surface (Grade 2)	CTP	\$560

**Specifiable Finishes**

Laminate (HPL)  
Solid Surface  
Veneer

**Reference Price Range**

List Price COM: \$10000-\$10960

Continued...

**Notes**

Pricing includes Freight within Continental US.

Customized sizes available upon request and subject to price increases.

Case wrap can be specified as full, open left, open right, or open both sides.

Does not include faucet, plumbing, and associated hardware.

For step-by-step specifications and quotes, access our live quote tool online at [memofurniture.com/quotes](http://memofurniture.com/quotes).

**Array Sink Stations**

Designed by George Simons Jr., 2017

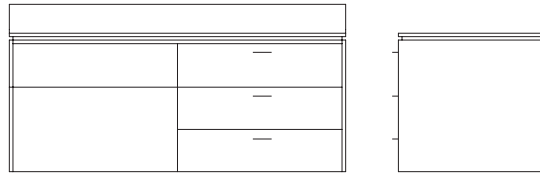

<b>Depth</b>	<b>Width</b>	<b>Height</b>
20.75"	46.25"	19.25"

<b>Product</b>	<b>Code</b>	<b>List Price COM</b>
Sink LSF + Drawer	GS02-S2-LSF	\$12000
Sink RSF + Drawer	GS02-S2-RSF	\$12000

**Standard with Core Product**

- Approved HPL Outer Case Wrap
- Approved HPL Drawers
- Drawer Pulls
- Solid Surface Top and Backsplash (Grade 1)
- Solid Surface Sink (Grade 1)
- White Melamine Carcass

**Laminates (HPL)**

For a list of approved HPL products see page 09. Non-approved HPL products will be priced on a case-by-case basis.

<b>Options</b>	<b>Code</b>	<b>List Price COM</b>
Bow Pull	P1	--
Tab Pull	P2	--
Straight Pull	P3	--
Drawer Liner	DL	\$100
Veneer Outer Case	VC	\$400
Solid Surface (Grade 2)	CTP	\$660

Continues...

Continued...

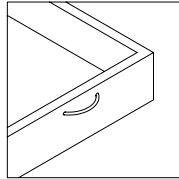

Bow Pull

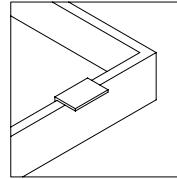

Tab Pull

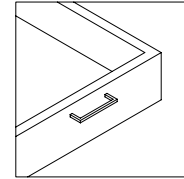

Straight Pull

**Specifiable Finishes**

Laminate (HPL)  
Solid Surface  
Veneer

**Reference Price Range**

List Price COM: \$12000-\$13160

**Notes**

Pricing includes Freight within Continental US.

Customized sizes available upon request and subject to price increases.

Case wrap can be specified as full, open left, open right, or open both sides.

Does not include faucet, plumbing, and associated hardware.

All pulls standard in Brushed Nickel.

For step-by-step specifications and quotes, access our live quote tool online at [memofurniture.com/quotes](http://memofurniture.com/quotes).

**memo**

Memo Furniture  
4660 Ohio Avenue South, Suite A  
Seattle, Washington 98134  
+1 206 995 8780  
memofurniture.com